

# TLQ Light



FLEET SIZE 14 | LENGTH 6058 MM | BREADTH 2438 MM | HEIGHT 2591 MM | ACCOMMODATES 4 OR 2 PEOPLE

## Compact Temporary Living Quarters for easy shipment worldwide

The TLQ Light is our most compact unit. This container-sized TLQ weighs just 6.5MT. Being the equivalent of a 20 ft ISO unit (TEU), the TLQ can be shipped all over the world by standard shipping lines, providing the ultimate flexibility at minimal cost.

Built to comply with all regulations, the TLQ Light is suitable for extreme environments and for any sector of the offshore industry or on board vessels.

Despite its compact size, there is ample space for four occupants in two cabins. Each unit has a wet cell with shower and toilet.

The units can be equipped with optional TV and Internet access.

The TLQ Light series is also available in a workshop/utility/laundry or locker room configuration.

TLQ Light

Compact Temporary Living Quarters for easy shipment worldwide

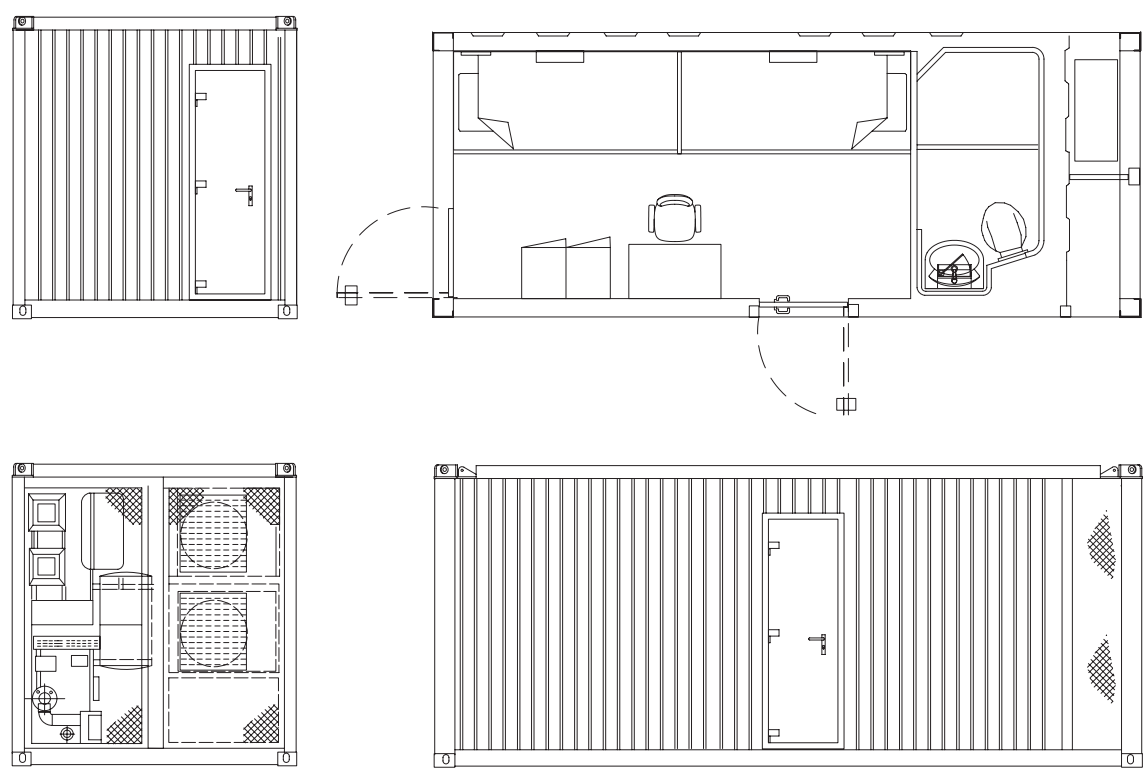

| GENERAL   |   |
|---|---|
| Build year  | 2009  |
| Fleet size  | 14  |
| Class   | DNV 2.7-1/ BS 12079. (CSC). Lloyd's Register for CSC.   |
| Certification   | A60/IMO/SOLAS/Zone 2 (optional)                         |
| DIMENSIONS  |   |
|   | 20' Standard CSC Container                              |
| Length  | 6058 mm   |
| Breadth   | 2438 mm   |
| Height  | 2591 mm   |
| Weight  | 6.5 MT  |
| Accommodates  | 4 or 2 people   |
| Framework Design Temperature                                | -20 °C to +50 °C  |
| Stacking Capability   | 5 high  |
| HVAC  | 2x 18,000 BTU Split Units. Internal design temp 24 °C   |
| Detection & Alarm System                                    | Connection to main rig/vessel alarm system is included. |
| HIGHLIGHTS  |   |
| Can be stacked five high to make maximum use of space.      |   |
| Weight and size facilitate cost effective transport.        |   |
| Plug & Play - Easy to hook up to any offshore installation. |   |

Details in this specification are correct at the time of publishing. However they may differ from time to time due to project specific alterations. Upon request project specific arrangements and specifications can be provided.

