

# TLQ Standard



FLEET SIZE 60 | LENGTH 6.3 M | BREADTH 3.2 M | HEIGHT 2.9 M | ACCOMMODATES 4 OR 2 PEOPLE

## Temporary Living Quarters built to maximise efficiency & comfort

The Seafox Standard TLQ answers the need for modern, flexible, cost efficient offshore accommodation.

Built to comply with North Sea regulations, the TLQ Standard fleet is suitable for worldwide use, including extreme environments and for any sector of the offshore industry or on board vessels.

Classed by Lloyd's Register, the TLQ Standard is a reliable, proven concept that has been deployed in some of the most hostile environments for many years. The TLQ Standard is designed for flexibility. At 6.3 m in length, they have a relatively small footprint making them cost efficient and they weigh only 8 MT. However, there is ample space for four occupants in two cabins, each with a bunk bed. To give that 'home away from home' feeling the units are equipped with all the modern day comforts, with each occupant having a (optional) wall-mounted TV and access to the Internet. In addition to accommodation units, Seafox can supply offices, recreation units, as well as laundry/washing/changing rooms.

# TLQ Standard

## Temporary Living Quarters built to maximise efficiency & comfort

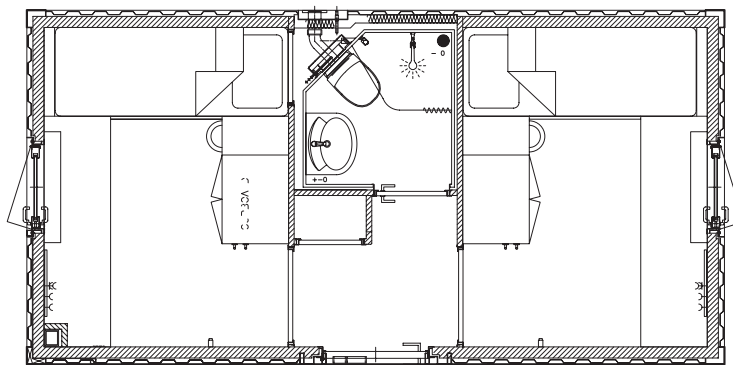
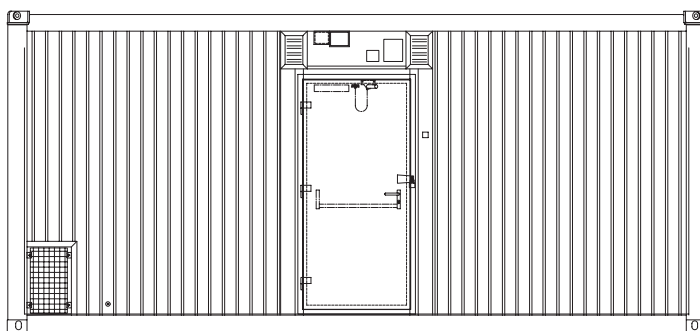
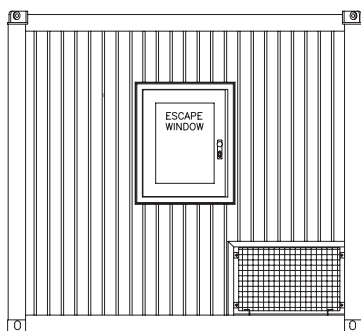

### GENERAL

Build year	2012
Fleet size	60
Class	Lloyd's Register, DNV 2.7-1
Certification	EN12079/ATEX 95 compliant/Zone 2/ A60/IMO/Solas

### DIMENSIONS

Length	6.3 m
Breadth	3.2 m
Height	2.9 m
Weight	8.2MT
Accommodates	4 or 2 people

### HIGHLIGHTS OF STANDARD TLQ

Can be stacked three high to make maximum use of space.  
Weight and size facilitate cost effective transport.  
Plug & Play - Easy to hook up to any offshore installation.

### COMFORT

Dedicated wet cell. Self-contained bathroom with shower, washbasin and toilet.  
Careful attention to spatial layout, use of light and modern colour scheme provide relaxing environment.  
Each unit has own HVAC and sprinkler system, smoke and gas detection and alarm.

Details in this specification are correct at the time of publishing. However they may differ from time to time due to project specific alterations.  
Upon request project specific arrangements and specifications can be provided.

